

General technical data:

Product brand name		SIRIUS
Product designation		wiring module reversing contactors S0, spring-loaded terminal
Size of the circuit-breaker		S0
Size of the contactor		S0
Design of the product		actuating voltage contactor: AC and DC
Acceptability for application		reversing starter kit

Installation/mounting/dimensions:

Type of fixing/fixation		clip-on
Height	mm	7.4

Further information:

Information- and Downloadcenter (Catalogs, Brochures,...)

<http://www.siemens.com/industrial-controls/catalogs>

Global Industry Mall (Online ordering system)

<http://www.siemens.com/industrial-controls/mall>

Service&Support (Manuals, Certificates, Characteristics, FAQs,...)

<http://support.automation.siemens.com/WW/view/en/3RA2923-2AA2/all>

Image database (product images, 2D dimension drawings, 3D models, device circuit diagrams, ...)

http://www.automation.siemens.com/bilddb/cax_en.aspx?mlfb=3RA2923-2AA2

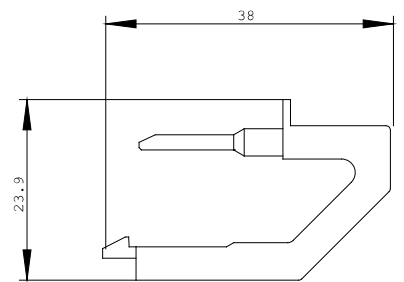
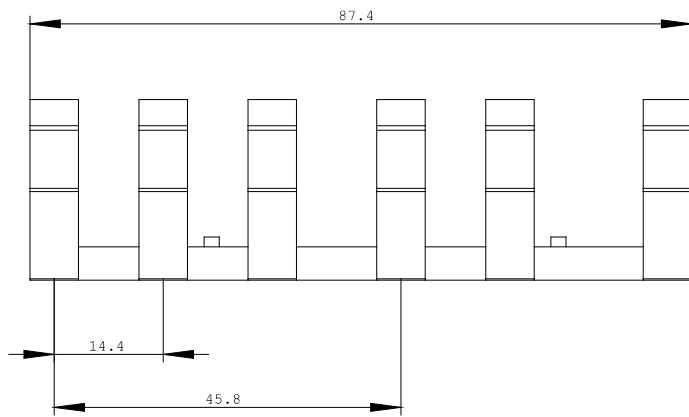
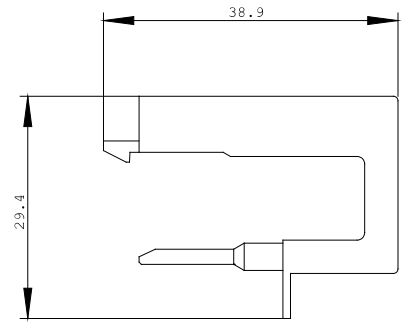
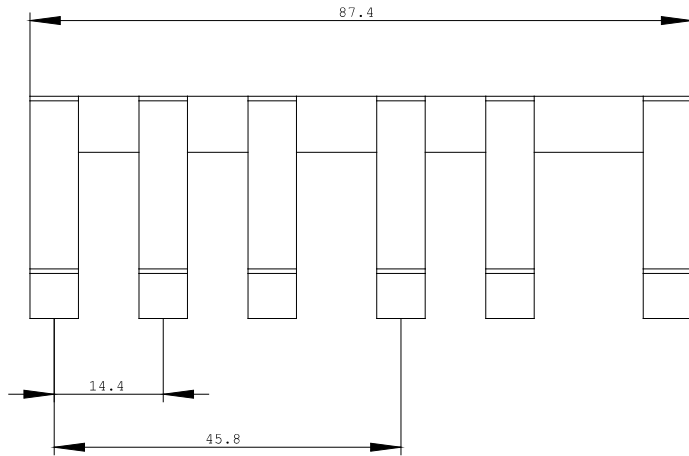

last change:

Apr 26, 2010